



Installing 30 LCRs in 20e LCR Holes

Lots of people have asked the question, “What if I have already roughed in for IWTS-20e LCRs—can I now install IWTS-30 LCRs in their place? This is your lucky day. The answer is Yes. There are two ways you could have roughed in a 20e LCR: Either with or without the IN-BOX-20LCR backbox. Either way, you’re all set.

Without the 20LCR Backbox

OK, here’s a picture (1) of the rough-in hole for an IWTS-20e LCR without the IN-BOX-20 LCR backbox. The cut-out hole is 17 13/16” H x 9 3/8” W. Note the Installation Bracket (IN-INST-20LCR)

installed in the cut-out.

Grab the Installation bracket and pull it out, leaving just the cutout (2).

Here comes the part where you’ll thank

us for being so smart: The new cutout hole for the IWTS-30 LCR needs to be larger than the existing hole for the 20e LCR. That’s a good thing, no?

The new hole needs to be 20 3/8” H x 11 1/8” W. Mark it as such on the wall (3). Now take your tool of choice and cut the new hole (4).

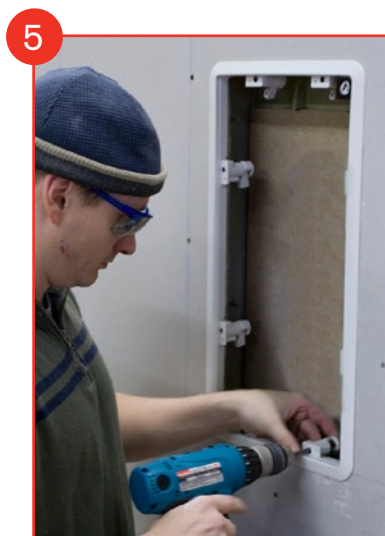

That’s it—you’re done. Now simply install the GFR-626 like you would for any IWTS-30 LCR install (5) and away you go. Treat the wall cavity acoustically as recommended in the 30 LCR’s Install Manual for best results.

See other side for
‘With the 20 LCR
Backbox.’

With the 20LCR Backbox

If the IN-BOX-20LCR is installed behind the sheetrock, the procedure is a little different, but still really easy. In this case, the IN-INST-20LCR bracket is already screwed to the BOX behind the

sheetrock, so you can't just pull the bracket out.

Here's what you do: First, mark the new hole with the template (1). Use your saw and cut the new hole in sheetrock,

through the bracket and Backbox (2). You'll have to remove the internal bracing (3) and stuffing (4) in the 20's BOX as you cut the new hole.

Install the GFR 626 in the new hole (5) and then install the 30 LCR into the GFR-626 (6). You're done And, yes, the IWTS-30 LCR will sound just fine in the IN-BOX-20. Relax.

